

GONU262 GPON ONU

GONU262 GPON ONU has one optical input, one GE at RJ-45 port and one GE at 75Ohm RF port, meeting the requirement of the broadband access network. It applies in FTTH/FTTO to provide data and video service based on GPON network. Besides regular GPON ONU's one GE auto-adapting Ethernet port, GONU262 has one extra GE at coaxial RF port. With built-in high performance 1000Base-T1 and 100Base-T1 Ethernet PHY transceiver, this RF port provides bidirectional gigabit access over up to 100meter coaxial cable, which enable FTTH to the main home entrance and gigabit Ethernet over coax cable to the room (CTTR). GONU262 is helpful for full WiFi coverage in the rooms.

The GONU262 features high-performance forwarding capabilities to ensure excellent experience with Internet and HD video services. It has good third-party GPON OLT compatibility.



Application:

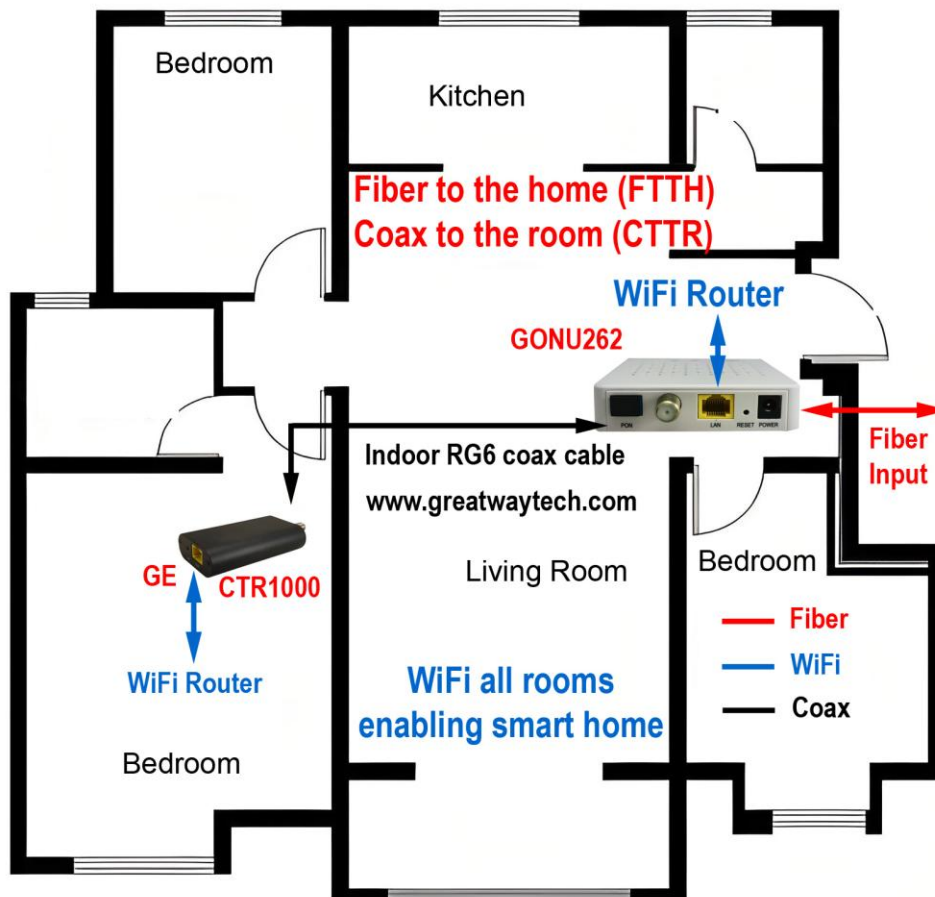

Features:

- CPU chip: RTL9601D-CG-VA3
- Comply fully with ITU-G.984.1/2/3/4 standard and G.987.3 protocol
- Support downlink 2.488 Gbps rate and uplink 1.244 Gbps rate
- Support bidirectional FEC and RS(255,239) FEC CODEC
- Support 32 TCONT and 256 GEMPORT
- Support AES128 decryption function of G.984 standard
- Support SBA and DBA dynamically broadband allocation
- Support the PLOAM function of G.984 standard
- Support Dying-Gasp check and report
- Support synchronous Ethernet
- Working with the main 3rd party OLTs
- Support the rogue ONU alarm function
- Down-link port 10/100/1000M auto-negotiation
- Support 1K MAC address table
- Extra GE Port at the coax 75Ohm RF port
- RF port supports bidirectional gigabit Ethernet over 100 meter coaxial cable
- RF port offering 12V DC to power the remote CTR1000 (RF to Ethernet) unit

Specifications

Item	Parameters	Specification
Interface	PON Port	1*GPON port, FSAN G.984.2 standard, Class B+ Downstream Data Rate: 2.488Gbps@1490nm Upstream Data Rate: 1.244Gbps@1310nm SC/PC single mode fiber 28dB Link loss
	Ethernet Port(LAN)	1*GE Auto-negotiation RJ45 port Full Duplex / Half-Duplex RJ45, Auto-MDI/MDI-X Cable Transmission Distance 100 Meter
	RF Port	1*GE at 75Ohm RF port IEEE 802.3bp 1000Base-T1 Standard Max Output: >49±0.5dBμV/8MHz@450MHz Min Input: <40±0.5dBμV/8MHz@450MHz@BER10-6 >16dB@88-650MHz RG6 Coaxial Cable Transmission Distance 100 Meter 12V DC to power the remote unit via coaxial cable
	Power Supply Port	12V DC input, Footprint: DC0005 ø2.1MM
Layer 3 Features	Network Management	Compliant OMCI interface as defined by ITU-T G.984.4 Support TR069 Remote Management and Upgrade Support WEB/CLI management
	WAN	Support Dynamic and Static IP WAN Support PPPOE WAN

	DHCP	Supports DHCP server, DHCP client, DHCP Client List Support static address allocation
Environmental Specifications	Shell	Plastic casing
	Power	External 12V 1A power supply adapter Power consumption: <6W
	Dimensions Weight	90mm(L) × 90mm(W) × 24mm (H) 0.1Kg
	Environment	Operating Temperature: 0~50 ℃ Storage Temperature: -40~85 ℃ Operating Humidity: 10%~90% (Non-condensing) Storage Humidity: 5%~95% (Non-condensing)

LED Indicator			Description
1	LAN	LAN port status	On: Ethernet connection is normal; Blinking: Data is being transmitted through the Ethernet port; Off: Ethernet connection is not set up;
2	LOS	GPON optical signals	On: Optical power lower than receiver sensitivity ; Off: Optical in normal
3	PON	ONU Register	On: Success to register to OLT; Blinking: In process of registering to OLT; Off: In process of registering to OLT;
4	T1	T1 Status	On: T1 is connected at the RF port Off: no T1 connection at the RF port
5	PWR	Power status	On: The ONU is power on; Off: The ONU is Power off;

Ordering Information

GONU262 (1*GE interface, 1 GPON interface, 1 T1 port, plastic casing, 12V DC adapter)